

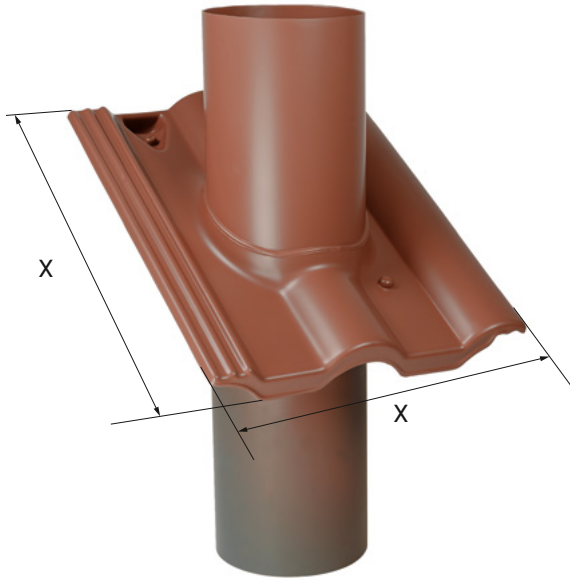

# FLECK Condensing boiler exhaust feedthrough tile DN 150–DN 500



X-dimensions as per tile type

## PRODUCT INFORMATION

FLECK condensing boiler exhaust feedthrough tiles are suitable for double-walled exhaust gas systems with fresh air duct on the outside and exhaust gas duct on the inside. They are completely painted in the colour of your choice. Individual custom-made products are possible after specifying the roof pitch, outer diameter of the exhaust gas pipe as well as the boiler type and manufacturer.

- The exact roof pitch, the roof batten size and the outer diameter of the fresh air pipe, as well as the boiler type and manufacturer must be specified
- Available in the dimensions: DN 150, DN 200, DN 250, DN 300, DN 400 and DN 500

### Note

When planning, take into account the internal diameters of the pipe routing according to the FLECK pipe table.

### Also available as alternative:

- Slate/shingle
- Corrugated profile 5 ~ 480 × 900 mm (small format)

### Material

All components are made of highly weather-resistant, durable special rigid PVC.

### Construction material (fire reaction) class

B2 as per DIN 4102



Can be used for double-wall ventilation pipes only!



Custom-made products are not returnable (cannot be exchanged)!



### Pipe table data sheet

[fleck-dach.de/en/services/downloads/](https://fleck-dach.de/en/services/downloads/)



## TECHNICAL NOTES

### Installation note

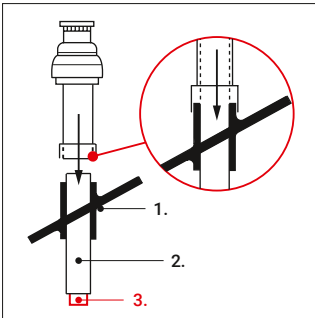

1. FLECK condensing boiler exhaust feedthrough tile
2. Fresh air pipe according to the exhaust gas system manufacturer
3. Exhaust gas pipe according to the exhaust gas system manufacturer

