



# FLECK Flex exhaust gas universal feedthrough variable DN 100, DN 125

## PRODUCT INFORMATION

The FLECK flex exhaust gas universal feedthrough variable in DN 100 and DN 125 adapts to all roof tiles with its lead substitute skirt.

### Material

- Tile moulding is made of highly weather-resistant, durable special rigid PVC
- Circumferential skirt made of lead substitute; universally adaptable
- The black collar is made of highly weather-resistant, durable special soft PVC
- Colours: Black, Red, Brown

### Construction material (fire reaction) class

B2 as per DIN 4102

### Note

Where draining copper or bitumen surfaces are exposed to water, the flexible flange must be surface treated. The surface can be treated, for example, with PERFORM Extra Protection.



X-dimensions as per tile type

**!** Can be used for double-wall ventilation pipes only!

## TECHNICAL NOTES

### Set roof pitch

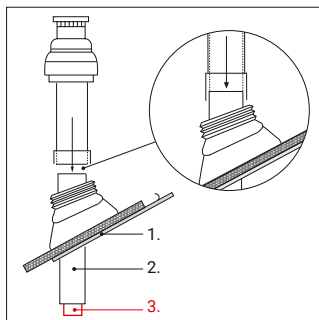

1. Universal feedthrough tile
2. Fresh air pipe
3. Exhaust gas pipe

### Installation note

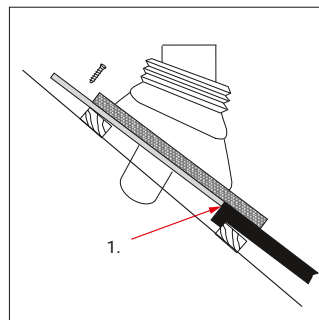

1. Base plate should abut in front of the tile if possible

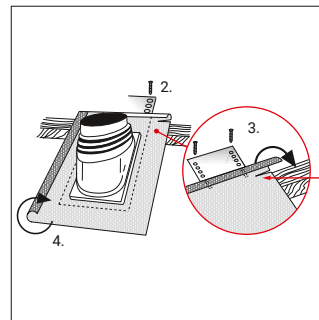

2. Drill holes in the base plate and screw in place
3. Cut horizontally above the roof batten and flange it to the front
4. Flanging the edge (water brake)

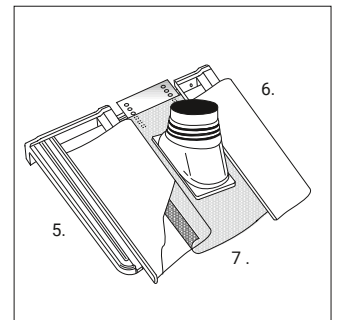

5. Place the tile on the water brake and press it on
6. Press back of tiles
7. Mould the skirt to the tile