



FLECK 4 in 1 flat roof vent



FLECK Flair head
For mechanical systems

PRODUCT INFORMATION

The 4 in 1 flat roof vent is suitable for mounting on all commercially available roof waterproofing. It combines four applications in one vent: Release fan, renovation vent, ventilator DN 100 and ventilator DN 125. The flange collar consists of either PVC, bituminous membrane or plastic or elastomer roofing membranes. The version with thermal insulation is optionally available.

Material

The main components of the vent are made of highly weather-resistant, durable special rigid PVC.

Construction material class

- B2 as per DIN 4102-4
- Bituminous membrane and plastic- or elastomer roofing membranes at least B2 (DIN 4102) or E (EN 13501)

Note

For outside-, inside diameters and wall thicknesses, please refer to the **Pipe table** (see QR code).

Optional accessories

Flair head DN 125 for mechanical exhaust air systems (see illustration).



Pipe table data sheet

fleck-dach.de/en/services/downloads/

TECHNICAL NOTES

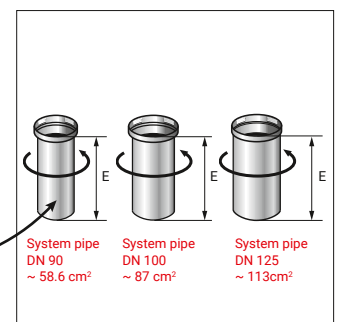
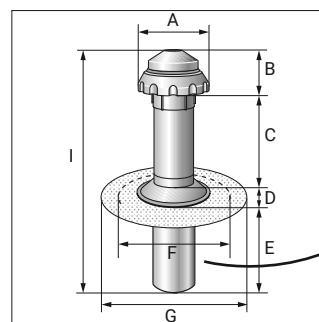
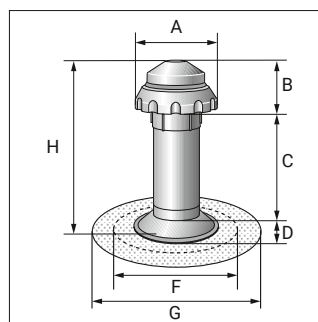
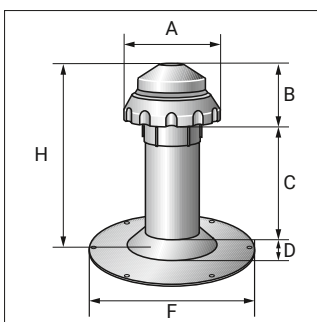



TECHNICAL NOTES

Material	Flange- or collar form	Dimensions (mm)								
		A	B	C	D	E	F	G	H	I
Rigid PVC flange	round	210	100	280	35	350	350	–	440	790
Bituminous membrane		210	100	280	35	350	350	470	440	790
Plastic or elastomer roofing membrane		210	100	280	35	350	350	470*	440	790

* Elevate = 450 mm

Dimensions in mm

Proper connection

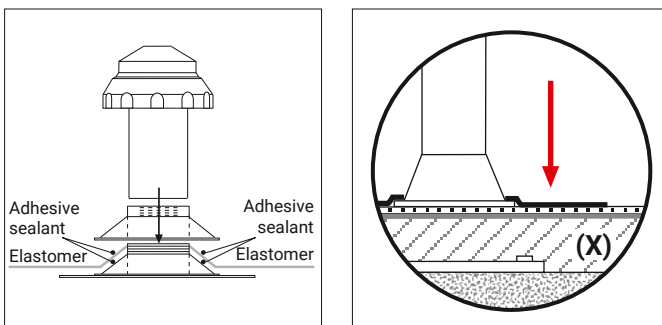

Proper connection to the untreated PVC-U flange is made according to the respective manufacturer's instructions for the roofing films and membranes used. When properly connecting the factory pre-assembled bitumen collar, make sure that the final top layer of bitumen is brought up to the edge of the vent support and welded tight (X) (see fig.). Do not expose the unprotected PVC components to direct flame! Proper connection to the factory pre-assembled film collars is carried out according to the respective specifications of the film manufacturer, e.g. with hot gas equipment, solvent welding agent, etc. If necessary, a processing test should be carried out beforehand. The air- and vapour-tight connection between the vent top part and system pipes DN 125/DN 100 is achieved by screwing in the system pipes. We recommend FLECK base elements in DN 90, DN 100 or DN 125 with an integrated backflow seal, as this eliminates the need to glue up extension elements.